

**INTERAGENCY AGREEMENT
BETWEEN
WASHINGTON STATE RECREATION AND CONSERVATION OFFICE
AND
LEWIS COUNTY CONSERVATION DISTRICT**

PARTIES TO THE AGREEMENT

This Interagency Agreement is made and entered into by and between the Washington State Recreation and Conservation Office, hereinafter referred to as "RCO", and Lewis County Conservation District, hereinafter referred to as "Lewis CD", pursuant to the authority granted by Chapter 39.34 RCW.

PURPOSE

Lewis CD will provide administrative and construction and engineering oversight of Boistfort Valley Water's project to construct a pre-sedimentation pond that will ensure continuity of potable water supplies in the event of another substantial flood like the 2007 flood event. In 2007, the water association was not able to fully serve its 800+ homes, three public schools and seven dairies for many months after the flood due to excess sedimentation and water contamination. A pre-sedimentation pond is essential to ensuring critical services (like potable water) are available during and after substantial flood events (like the 2007 flood). The project is anticipated to take approximately one month and will be completed well before June 30, 2017.

Project timeline is:

- May – August 2016 – Construction Contractor Hired.
- July – October 2016 – Construction Completed.
- November 2016 – Final Project Approvals and Authorizations Granted.

PERIOD OF PERFORMANCE

This Agreement shall become effective **March 23, 2016** or once fully signed, whichever is later, and will expire on **June 30, 2017**, except as clarified in this term below and/or unless terminated sooner or extended as provided herein.

Funding for this project is appropriated through June 30, 2017. This agreement may be extended to include work in FY 2017 as needed and if funding is available.

STATEMENT OF WORK

Lewis CD shall provide the following services to RCO related to flood hazard reduction in the Chehalis Basin and in support of the Chehalis River Basin Flood Authority:

See Attachment A - 2015-17 Small Projects Recruitment Form (dated September 29, 2014) as well as "Purpose" as stated above.

COMPENSATION

RCO shall reimburse Lewis CD, an amount not to exceed Three Hundred Thirty-Two Thousand and Three Hundred and Fifty Dollars (**\$332,350**), including any applicable tax and indirect costs, for the performance of all things necessary for, or incidental to, the work as set forth in this Agreement.

Allowable costs shall include costs incurred by Lewis CD from the first date of the Agreement period until the Agreement is terminated or expires as provided herein, but in no event shall allowable costs exceed the maximum amount of the Agreement. Costs allowable under this Agreement are based on the following agreed budget.

CATEGORY	DOLLARS
Salaries and Wages	\$43,600
Goods and Services	\$57,750
Construction Contracts	\$231,000
TOTAL	\$332,350

Lewis CD, shall be allowed to move amounts not to exceed ten percent of any object or expenditure total between objects. However, no change or transfer can be made that would have the effect of increasing the total budget. Budget changes in excess of this ten percent may be made only upon the written approval of both parties to this Agreement.

BILLING AND PAYMENT

RCO will pay Lewis CD upon acceptance of service provided and receipt and approval of a properly completed invoice, which shall be submitted not more frequently than monthly to RCO's representative as designated in the Administration section below.

The invoice shall describe and document, to RCO's satisfaction, a description of the work performed, staff charges, any travel costs, indirect cost calculations, and fees. Lewis CD shall also include adequate supporting documentation and include a reference to RCO Interagency Agreement Number 15-1526. If expenses are invoiced, Lewis CD shall provide a detailed breakdown of each type.

Payment shall be considered timely if made by RCO within thirty (30) calendar days after receipt of the properly completed invoice. Payment shall be sent to the address designated by Lewis CD.

RCO may, in its sole discretion, terminate the contract or withhold payments claimed by Lewis CD for services rendered if Lewis CD fails to satisfactorily comply with any term or condition of this contract.

No payment in advance or in anticipation of services or supplies to be provided under this contract shall be made by RCO.

ADMINISTRATION

The following individuals are designated as representatives of the respective parties. The representatives shall be responsible for the administration of this Agreement and for coordinating and monitoring

performance under this Agreement. In the event such representatives are changed, the party making the change shall notify the other party.

Lewis CD's representative shall be Bob Amrine, 1554 Bishop Road, Chehalis, WA, 98532, 360-748-0083, bob.amrine@wa.usda.gov or his successor.

RCO's representative shall be Scott Robinson, PO Box 40917, Olympia, WA 98504-0917, 360-902-0207, scott.robinson@rco.wa.gov or his successor.

DISPUTES

Disputes arising under this Agreement shall be resolved by a panel consisting of one representative from RCO, one representative from Lewis CD, and a mutually agreed upon third party. The dispute panel shall thereafter decide the dispute with the majority prevailing. Neither party shall have recourse to the courts unless there is a showing of noncompliance or waiver of this section.

TERMINATION

Either party may terminate this Agreement upon thirty (30) days written notice to the other party. In the event of termination of this Agreement, the terminating party shall be liable only for performance rendered prior to the effective date of termination.

CHANGES, MODIFICATIONS AND AMENDMENTS

This Agreement may be waived, changed, modified, or amended only by written agreement executed by both parties hereto.

EXECUTION

We, the undersigned, agree to the terms of the foregoing Agreement.

LEWIS COUNTY CONSERVATION DISTRICT

Bob Amrine, District Manager

March 24, 2016
Date

STATE OF WASHINGTON
RECREATION AND CONSERVATION OFFICE

Scott Robinson, Deputy Director

3/28/16
Date

RECEIVED

MAR 25 2016

WA STATE
RECREATION AND CONSERVATION OFFICE



2015-17 Small Projects Recruitment Form

Chehalis River Basin Flood Relief

What are small projects? -- In general, small projects are those projects that provide predominantly localized benefit, are capable of being completed within the funding cycle, are supported by the jurisdiction within which the project is proposed, and are vetted and advanced through the Chehalis River Basin Flood Authority's Chehalis Basin Projects Committee.

Instructions:

- a. Please submit project requests (via this form) to Scott Boettcher (scottb@sbgh-partners.com) no later than 5:00 p.m. September 10, 2014 September 30, 2014.
- b. Please submit individual project request forms for each project in your jurisdiction, even those projects previously or partially funded in the past.
- c. Note: Parts III and IV below [marked by "(**)"] will be scored as part of the Chehalis Basin Projects Committee's review and evaluation. Part I and II will not be scored.

Part I General	
1. Date:	Sept 29, 2014
2. Project Name:	BOISTFORD VALLEY WATER PRE-SEDIMENTATION POND
3. Project Location -- Please identify the location of the project as precisely as possible, preferable with latitude/longitude coordinates.	T12N R4W SECTION 24 2237 WILDWOOD ROAD CURTIS, WA 98538
4. Project Contact -- Please identify who will be responsible for overseeing and managing the project (i.e., name, email, telephone number, etc.).	RICHARD EITEL reitelre@msn.com 360 520-3627 748-1285
5. Lead Organization -- Please identify the lead organization, agency, entity, etc. responsible for this project.	LEWIS COUNTY



Part II Description, Timing and Cost	
6. Project Description -- Please describe the project, what it is intended to accomplish, and the benefits that will accrue and to whom.	A COLLECTION BASIN TO REMOVE SEDIMENT FROM RAW INTAKE WATER BEFORE TREATMENT
7. Project Timeline -- Please describe the overall timeline for completion of the project as well as any interim stages or phases.	1 MONTH
8. Project Cost and Funding -- What is the cost of this project? What are the on-going maintenance and operation requirements? Is it clear who will be responsible for on-going maintenance and operations costs?	COST \$289,000 BOISTFORD VALLEY WATER WILL BE RESPONSIBLE FOR ALL ONGOING MAINTENANCE & OPERATIONS COST
9. Other Funding -- Please explain the extent to which other funding sources or funding partners are available.	LOANS THROUGH USDA RURAL DEVELOPMENT OR STATE REVOLVING FUND MAY BE AVAILABLE
Part III (**) Completion and Doability by June 30, 2017	
10. Project Completion -- Does the funding requested complete (or substantially complete) a project that has already been started? If so, please explain.	NO
11. Project Doable -- Can this project or the stage/phase for which funding is sought be completed by June 30, 2017?	YES
12. Project Impacts -- Please identify how any project impacts will be mitigated and if that mitigation will be accomplished by June 30, 2017?	EXCESSIVE SEDIMENT IN RAW WATER WILL BE REMOVED BEFORE TREATMENT AND WOULD BE ACCOMPLISHED BY JUNE 30, 2017
Part IV (**) Benefits Stated and Quantified	
13. Emergency Response -- Please explain how this project enhances our ability to respond in a flood emergency (e.g., does it keep critical access roads, transportation facilities, etc. open and functional.)	THIS PROJECT WILL ALLOW A PUBLIC TO FUNCTION DURING A FLOOD EMERGENCY



<p>14. Essential Infrastructure Protection -- Please explain how this project protects essential infrastructure (as well the risks or consequences of not acting this funding cycle).</p>	<p>THIS PROJECT PROTECTS A WATER TREATMENT FACILITY FROM DAMAGE DUE TO EXCESSIVE SEDIMENT LOADS DURING HEAVY RAINFALL & FLOODING TREATMENT PLANT WOULD BE INOPERABLE OTHERWISE</p>
<p>15. Public Health, Safety and Welfare -- Please explain how this project protects public health, safety and welfare.</p>	<p>PROTECTS AGAINST WATER CONTAMINATION IN PUBLIC DRINKING WATER SUPPLY.</p>
<p>16. Residential, Commercial and/or Agricultural Protection -- Please explain how this project protects residential, commercial and/or agricultural interests and communities and the benefits of acting (or consequences of not acting) this funding cycle. Consider factors like number of structures at risk, number of people at risk, historic frequency of flood damage, magnitude of benefit to be gained for the cost, etc.).</p>	<p>BOISTFORD DAILEY WATER IS A COMMUNITY PUBLIC WATER SUPPLY THAT SERVES 800 HOMES, 3 PUBLIC SCHOOLS AND 7 DAIRIES. FLOODS OCCUR EVERY 3-5 YEARS</p>
<p>17. Other Project Impacts -- Please explain how this project impacts or is potentially impacted by another project.</p>	<p>Logging projects upstream potentially impact this project</p>
<p>18. Anything Else -- Please feel free to offer any additional information (e.g., photos, maps, drawings, etc.) that would be helpful to better understand the scope, timeline and benefits of this project.</p>	<p>included as attachments</p>

**Boistfort Valley Water
Wildwood WTP Sediment Basin
Preliminary Cost Estimate**

<u>NO</u>	<u>DESCRIPTION</u>	<u>QUANTITY</u>	<u>UNIT PRICE</u>	<u>AMOUNT</u>
1	Mobilization and Demobilization	1 LS	\$ 18,000	\$ 18,000
2	Clearing and Grubbing	1 LS	\$ 40,000	\$ 40,000
3	Sitework	1 LS	\$ 50,000	\$ 50,000
4	Unsuitable Excavation	20 CY	\$ 35	\$ 700
5	Gravel Borrow	100 TN	\$ 15	\$ 1,500
6	Foundation Gravel	200 CY	\$ 40	\$ 8,000
7	Crushed Surfacing Top Course	125 TN	\$ 28	\$ 3,500
8	Crushed Surfacing Base Course	250 TN	\$ 28	\$ 7,000
9	Erosion Control	1 LS	\$ 5,000	\$ 5,000
10	Restoration and Fencing	1 LS	\$ 25,000	\$ 25,000
11	Piping, Valves and Appurtenances	1 LS	\$ 20,000	\$ 20,000
Subtotal				\$ 178,700
Washington State Sales Tax (7.8%)				\$ 13,939
Subtotal				\$ 192,639
Contingency (20%)				\$ 38,528
Total Estimated Construction Cost				\$ 231,000
Engineering and Construction Management (25%)				\$ 57,750
TOTAL ESTIMATED PROJECT COST				\$ 289,000

PROPOSED WILLOW SEDIMENT POND ADDITION Attachment A

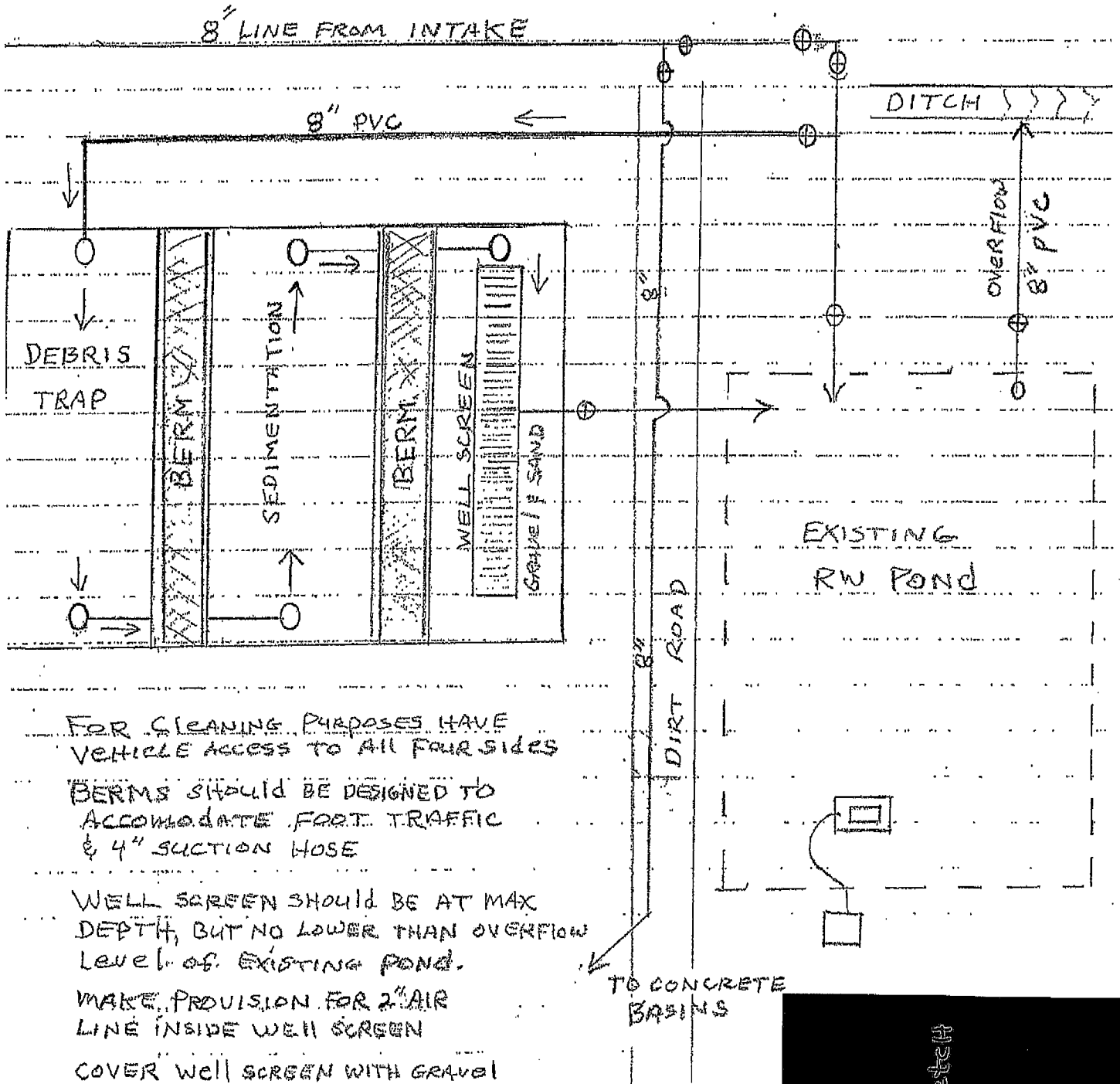

FOR CLEANING PURPOSES HAVE
VEHICLE ACCESS TO ALL FOUR SIDES

BERMS SHOULD BE DESIGNED TO
ACCOMMODATE FOOT TRAFFIC
& 4" SUCTION HOSE

WELL SCREEN SHOULD BE AT MAX
DEPTH, BUT NO LOWER THAN OVERFLOW
LEVEL OF EXISTING POND.

MAKE PROVISION FOR 2" AIR
LINE INSIDE WELL SCREEN

COVER WELL SCREEN WITH GRAVEL
FOLLOWED BY COARSE SAND.

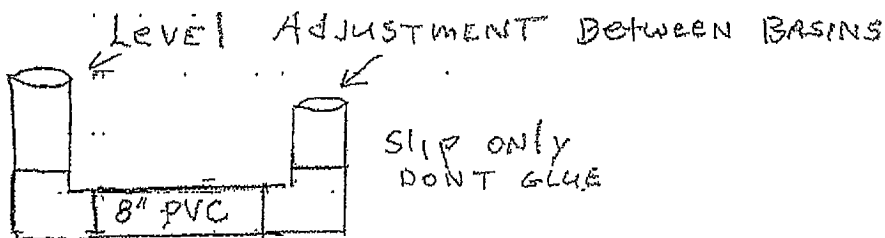

SLIP ONLY
DONT GLUE

NOTE:
NOT TO SCALE,
PREDESIGN SKETCH
OF PROPOSED
SEDIMENTATION
BASIN.

7/12/14