

# CONNOR CREEK EROSION CONTROL PROJECT GRAYS HARBOR COUNTY MONTESANO, WASHINGTON

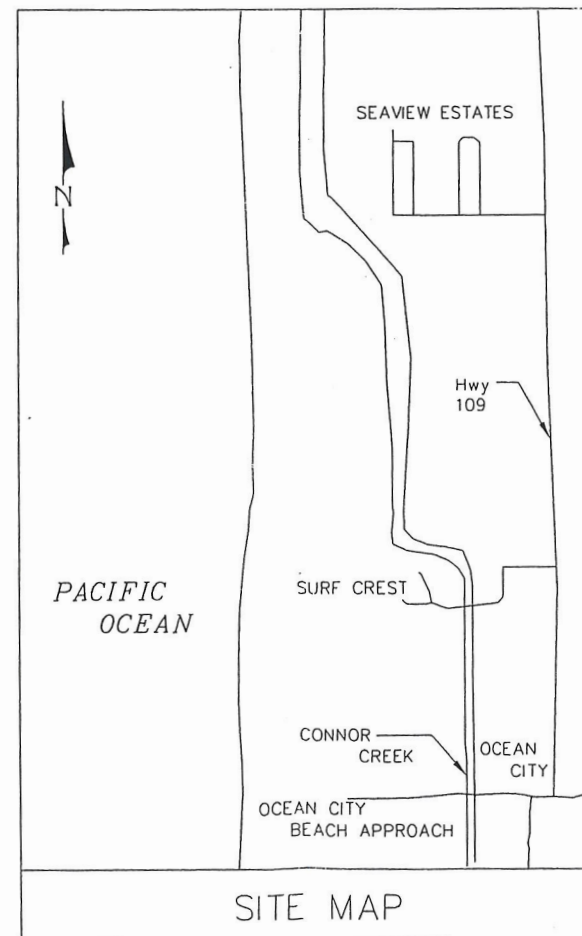

DRAWING INDEX

TITLE SHEET	
GENERAL PLAN	
A-1	ALTERNATIVE 1 - ROCK DIKE CONFINED CHANNEL
A-2	ALTERNATIVE 2 - GEOTUBE CONFINED CHANNEL
A-3	ALTERNATIVE 3 - WOOD PILE WALL AND WOODY DEBRIS BARRIER
A-4	ALTERNATIVE 4 - VEGETATED BANK CONFINED CHANNEL
A-5	ALTERNATIVE 5 - ROCK DIKE CHANNEL MIGRATION CORRIDOR
A-6	ALTERNATIVE 6 - COMPOSITE MIGRATION CORRIDOR
A-7	ALTERNATIVE 7 - GEOTUBE BARRIER REINFORCEMENT
A-8	ALTERNATIVE 8 - PEDESTRIAN BRIDGE
A-9	ALTERNATIVE 9 - SINGLE BURIED ROCK BARRIER

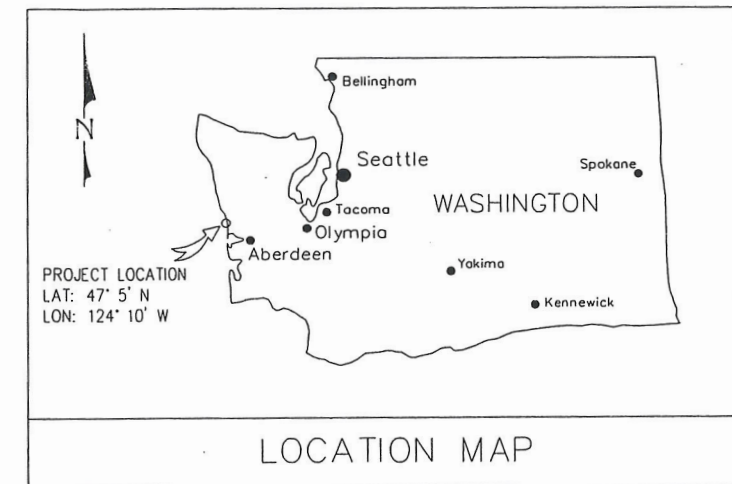
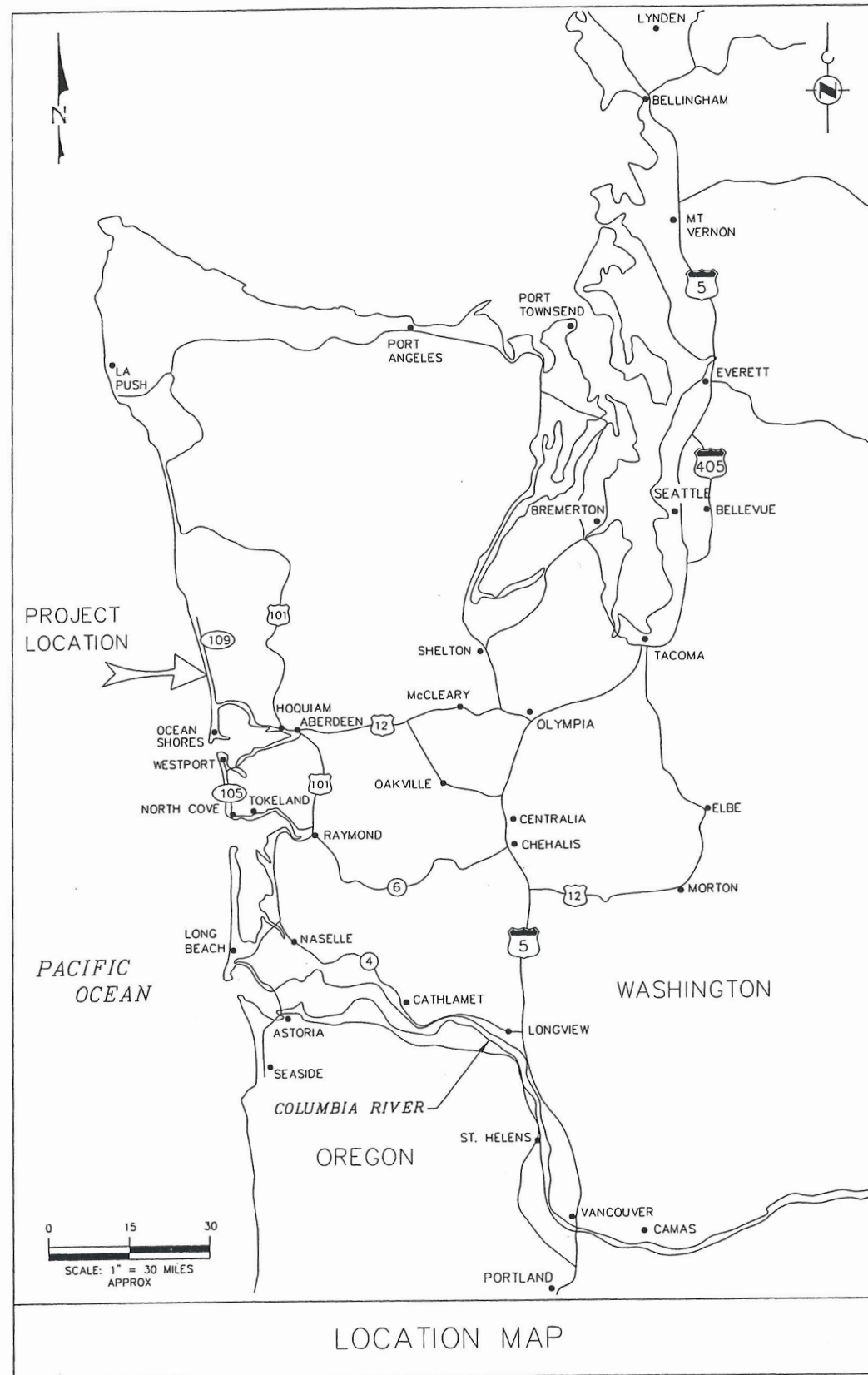
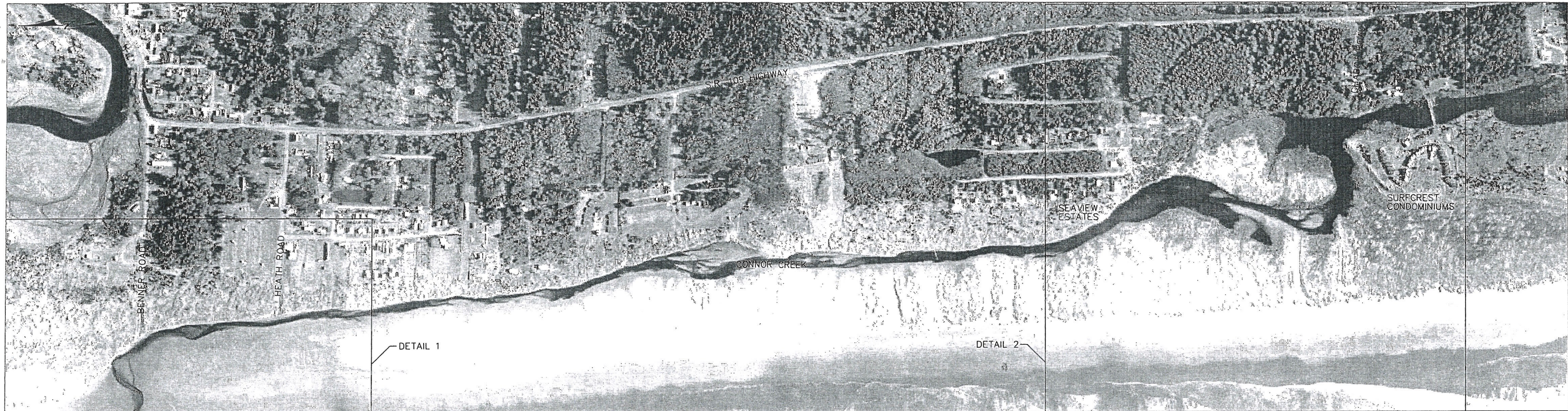

AREA MAP — CONNOR CREEK  
1"=800'

NOTES:  
1. AREAL PHOTO DATED NOV. 16, 2000.

**PACIFIC INTERNATIONAL ENGINEERING PLLC**  
 310 Waterfront Park Bldg.  
 144 Railroad Avenue  
 Edmonds, WA 98020  
 Phone (425) 744-7700  
 Fax (425) 744-1400

GENERAL PLAN — CONNOR CREEK

GRAYS HARBOR COUNTY CONNOR CREEK EROSION CONTROL PROJECT	
DATE: APR 30, 2001	FIGURE

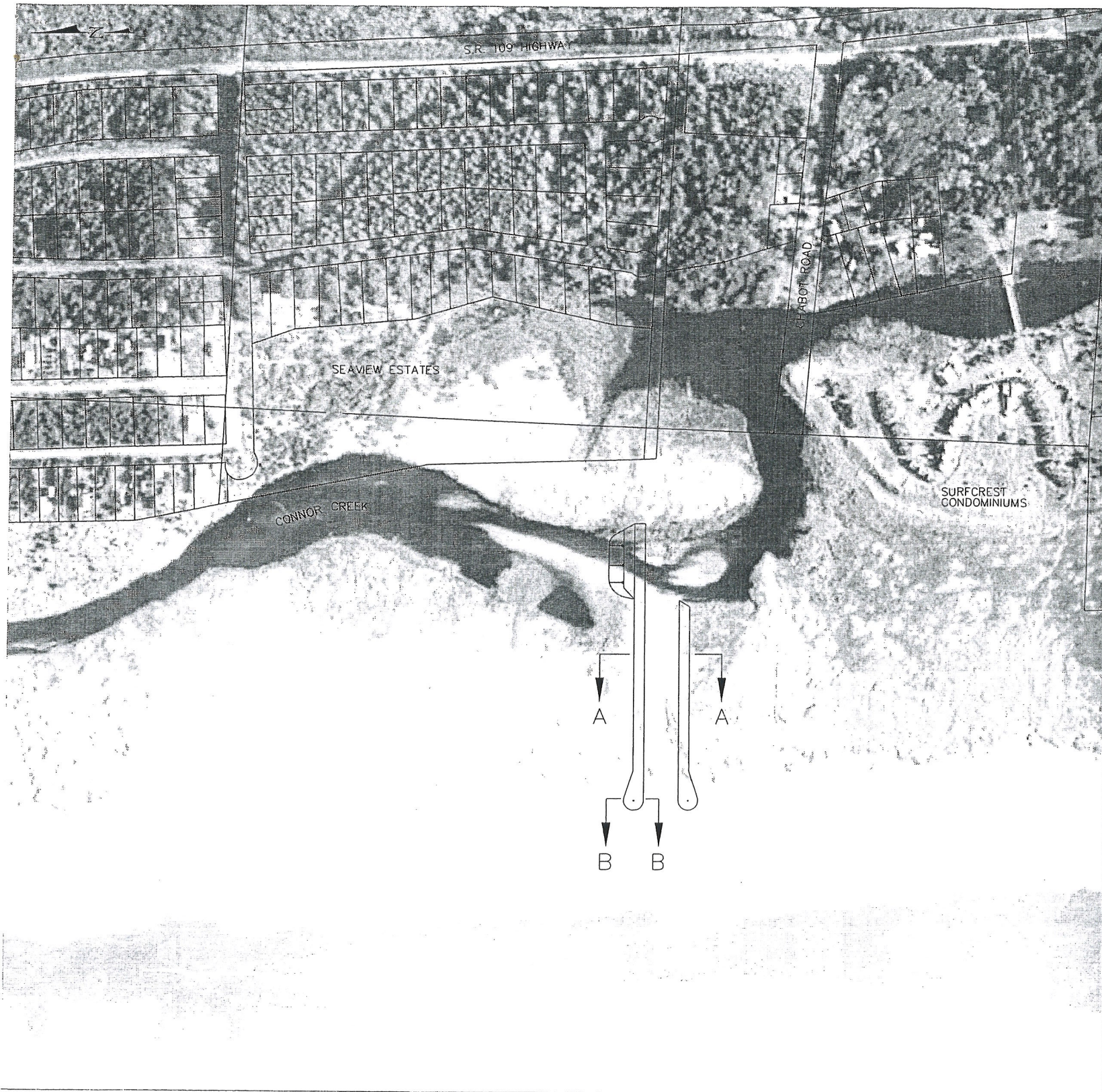

DETAIL 2  
1" = 400'

NOTES:

1. SURVEY VERTICAL CONTROL NAVD88  
MHHW = +8.4 FEET  
MLLW = -0.98 FEET
2. PROPERTY LINES SHOWN ARE APPROXIMATE LOCATION.

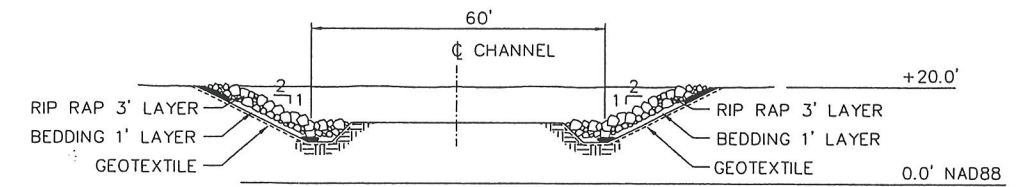

SECTION A-A  
ROCK DIKE CONFINED CHANNEL, TYPICAL

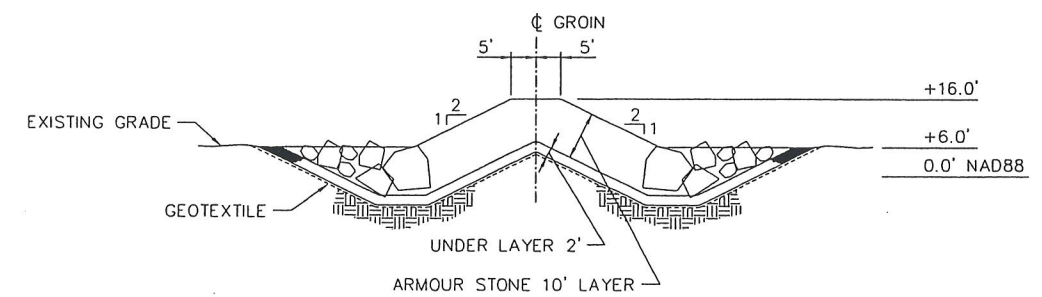

SECTION B-B  
ROCK DIKE CONFINED CHANNEL, TYPICAL

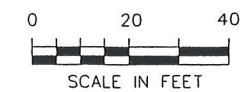

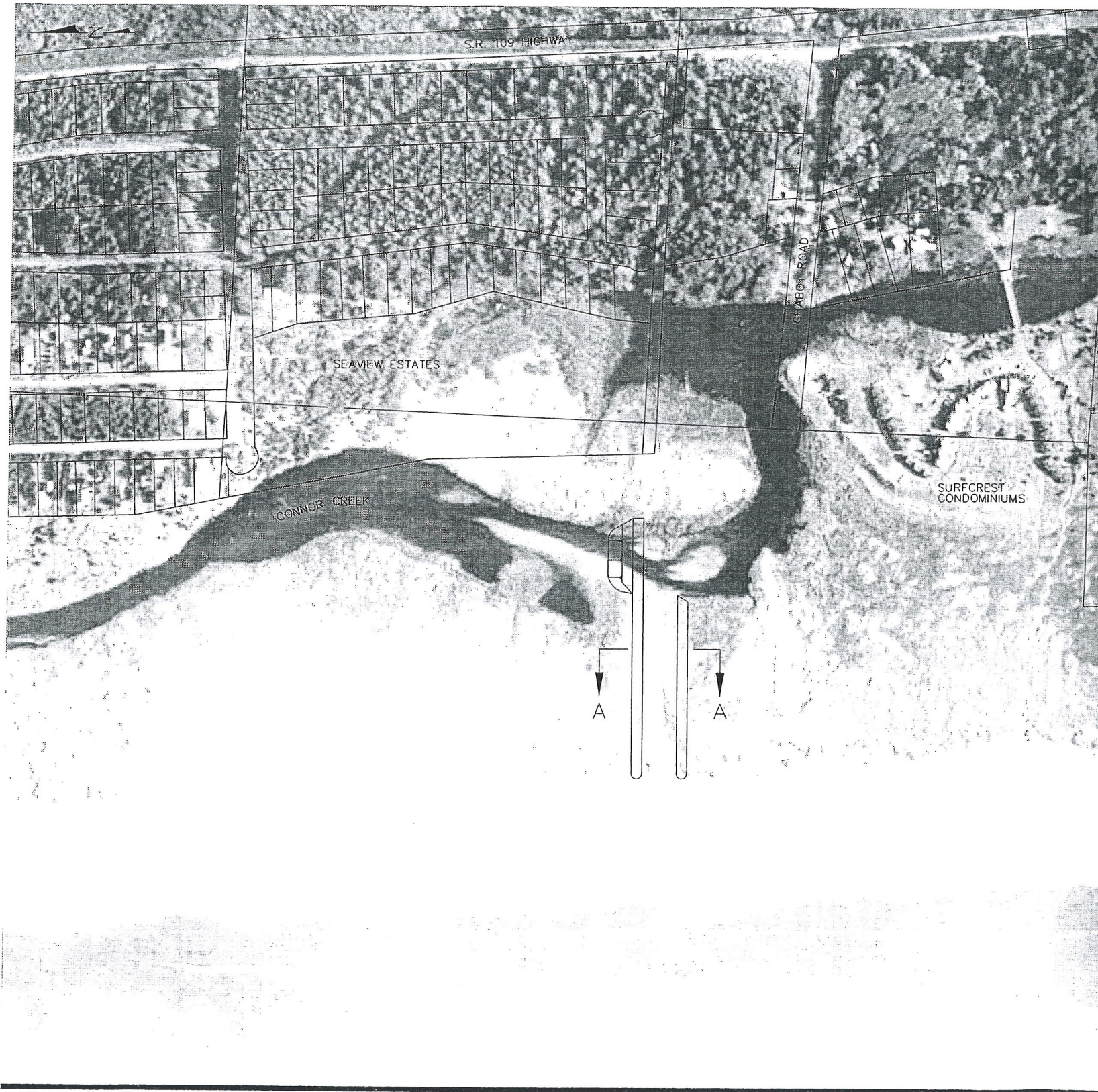

**NOTES:**

1. SURVEY VERTICAL CONTROL NAVD88  
 MHHW = +8.4 FEET  
 MLLW = -0.98 FEET
2. PROPERTY LINES SHOWN ARE APPROXIMATE LOCATION.

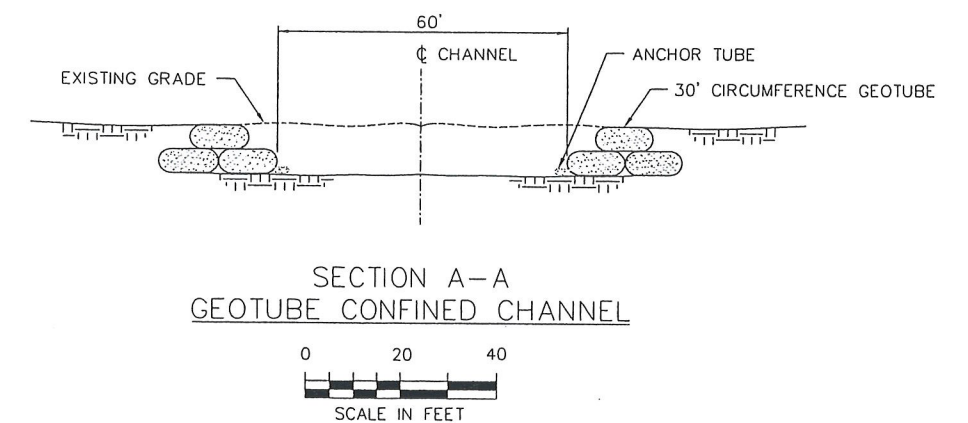

DETAIL 2  
 1" = 400'

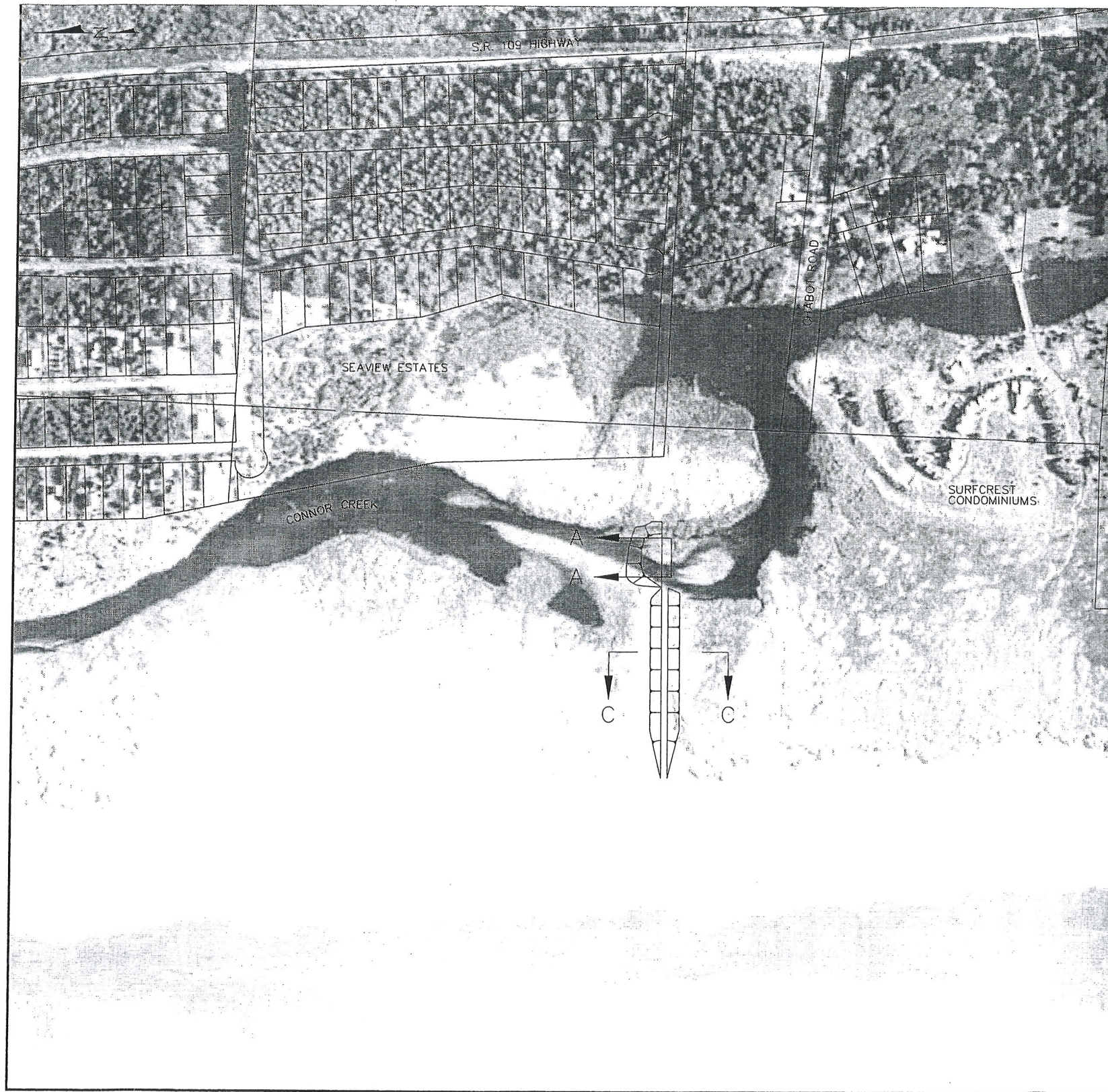

DETAIL 2  
1" = 400'

NOTES:

1. SURVEY VERTICAL CONTROL NAVD88  
MHHW = +8.4 FEET  
MLLW = -0.98 FEET
2. PROPERTY LINES SHOWN ARE APPROXIMATE LOCATION.

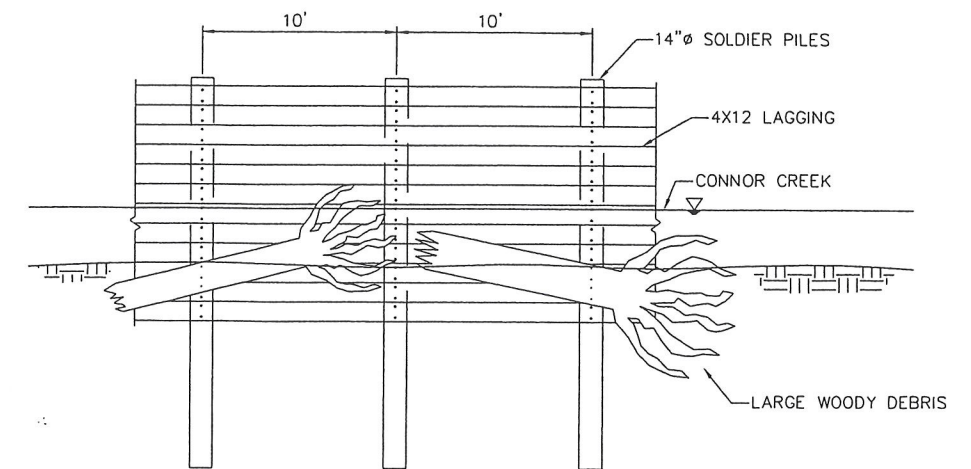

ELEVATION A-A, TYPICAL

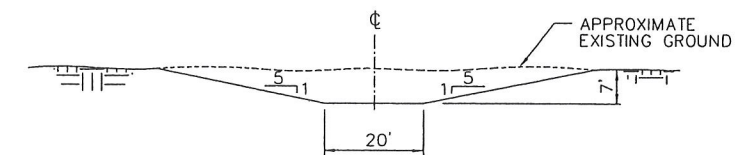
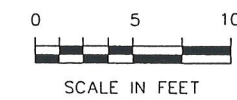

SECTION C-C  
EXCAVATED CHANNEL, TYPICAL



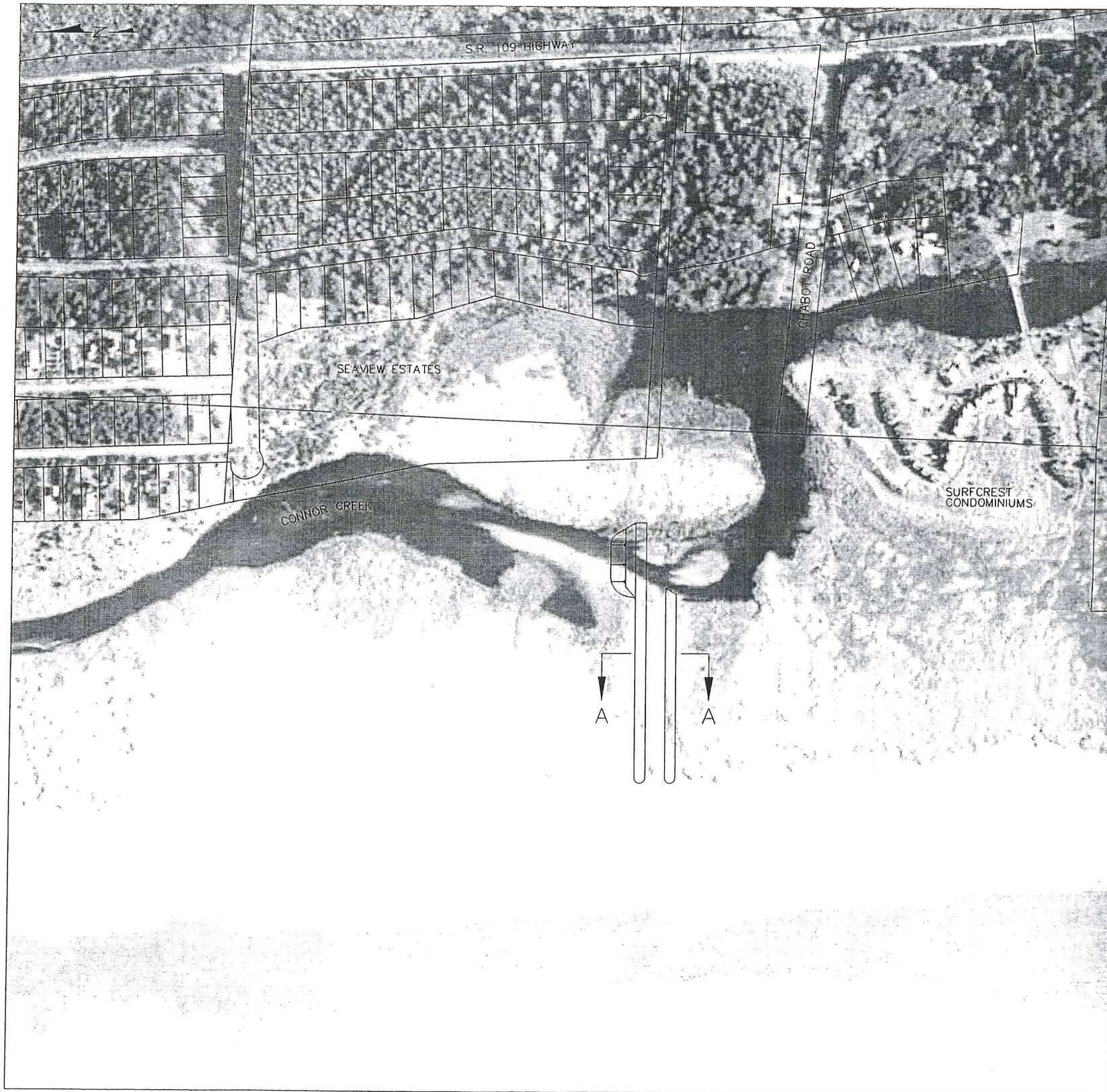

**NOTES:**

1. SURVEY VERTICAL CONTROL NAVD88  
MHHW = +8.4 FEET  
MLLW = -0.98 FEET
2. PROPERTY LINES SHOWN ARE APPROXIMATE LOCATION.

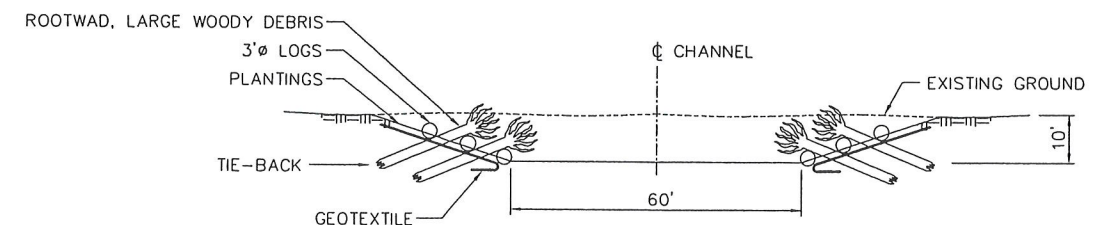

SECTION A-A  
VEGETATED BANK CONFINED CHANNEL, TYPICAL

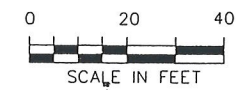

DETAIL 2  
1" = 400'

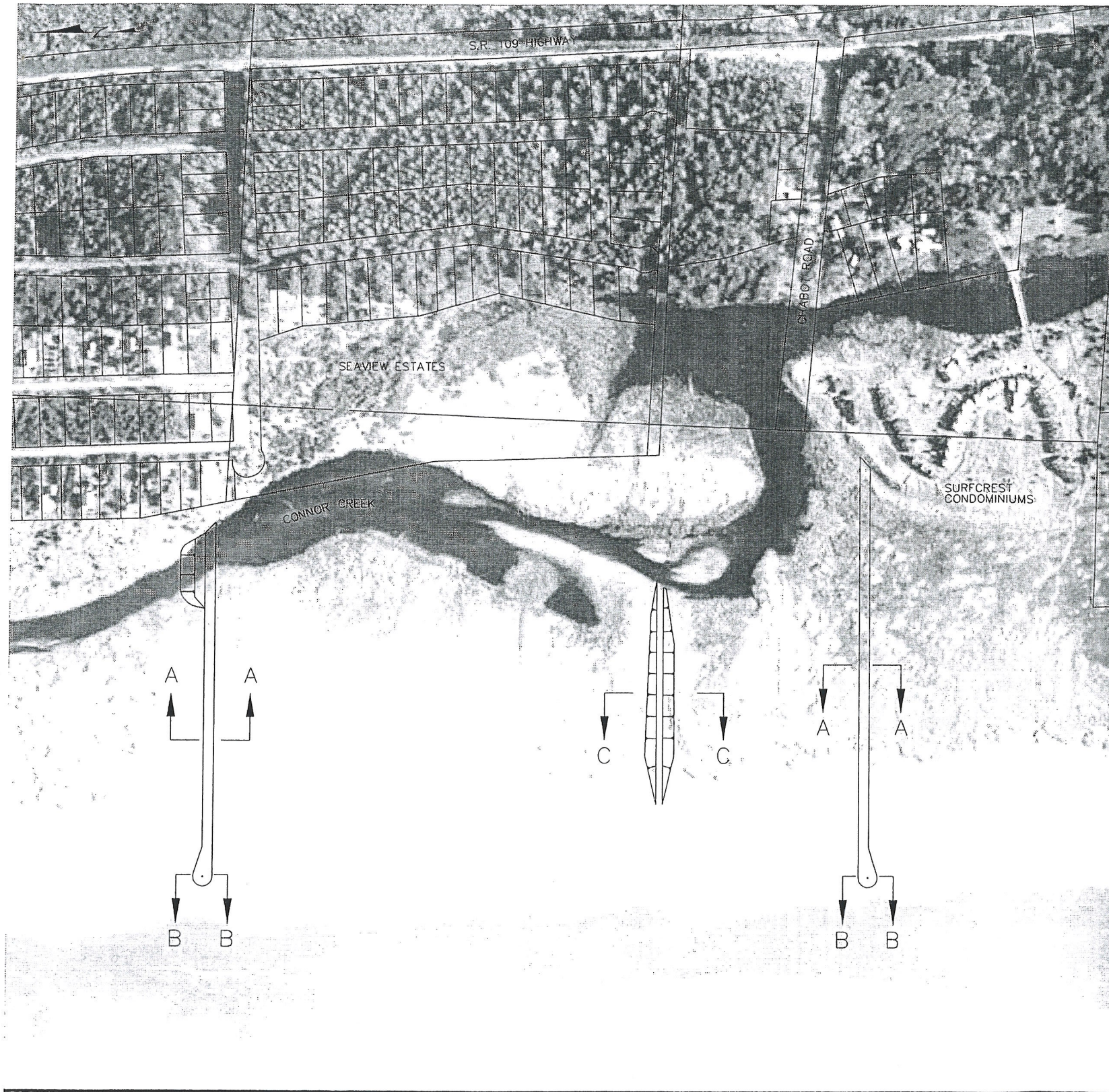

DETAIL 2  
1" = 40'

**NOTES:**

1. SURVEY VERTICAL CONTROL NAVD88  
MHHW = +8.4 FEET  
MLLW = -0.98 FEE
2. PROPERTY LINES SHOWN ARE APPROXIMATE LOCATION.

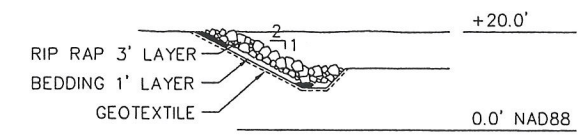

SECTION A-A  
ROCK DIKE, TYPICAL

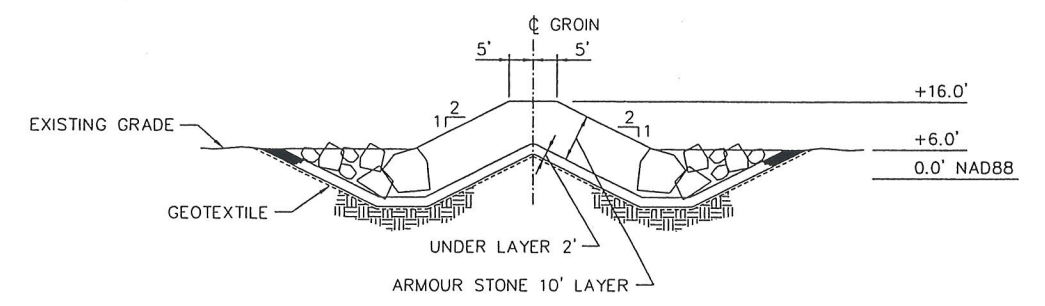

SECTION B-B  
ROCK DIKE SEAWARD END, TYPICAL

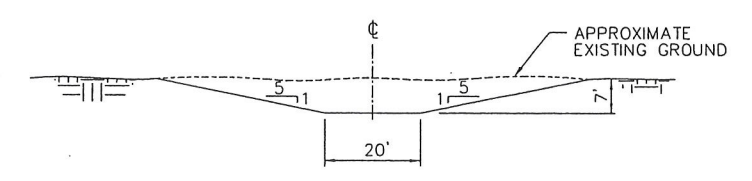

SECTION C-C  
EXCAVATED CHANNEL, TYPICAL

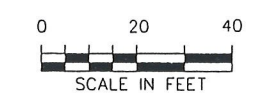

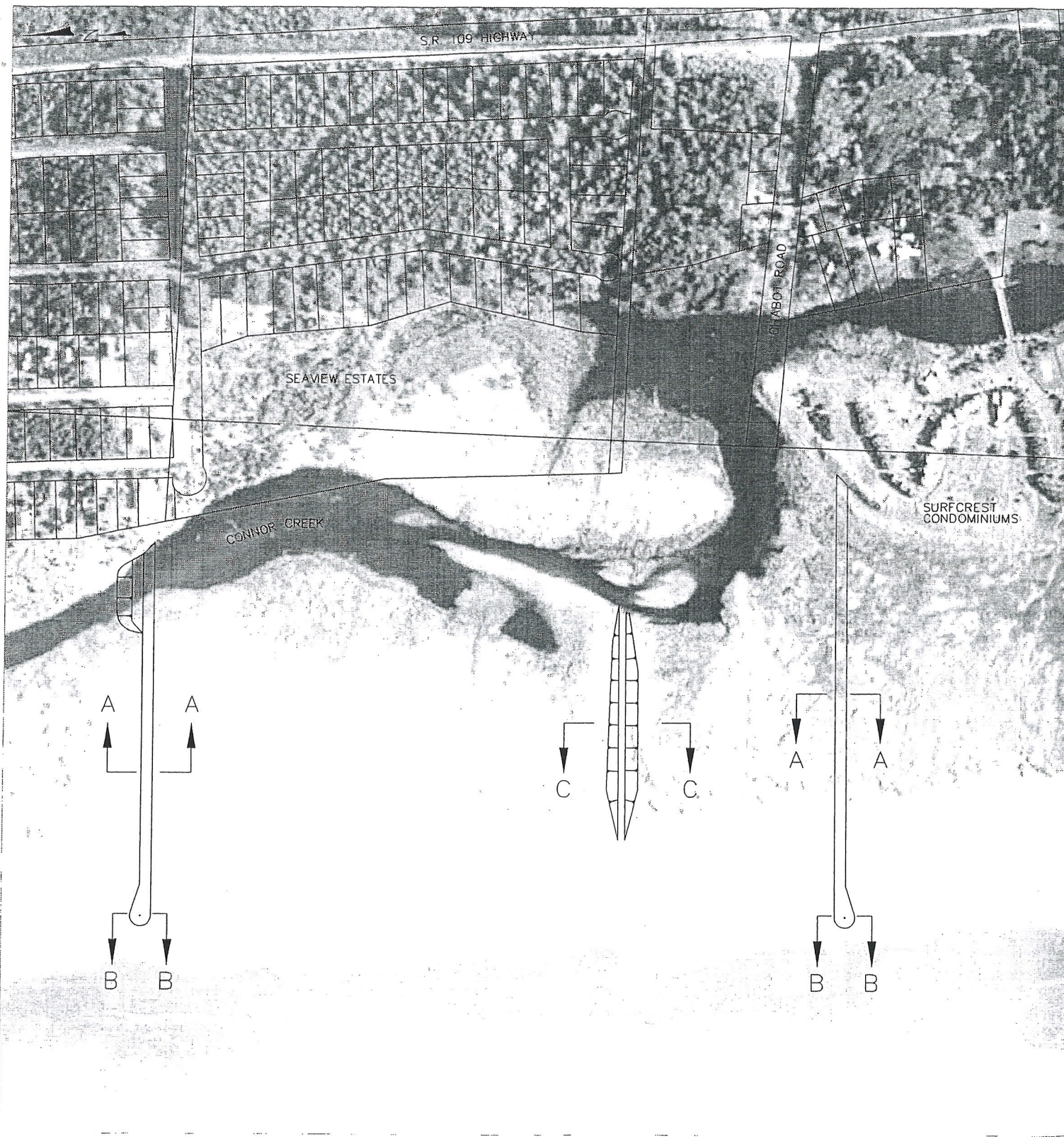

DETAIL 2  
1" = 400'

NOTES:

1. SURVEY VERTICAL CONTROL NAD88  
MHHW = +8.4 FEET  
MLLW = -0.98 FEET
2. PROPERTY LINES SHOWN ARE APPROXIMATE LOCATION.

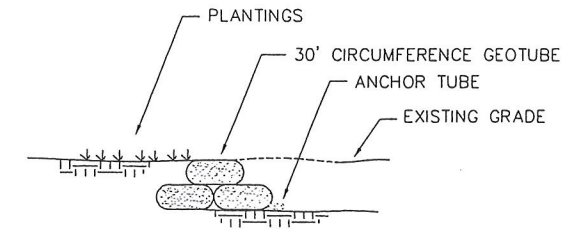

SECTION A-A  
GEOTUBE DIKE, TYPICAL

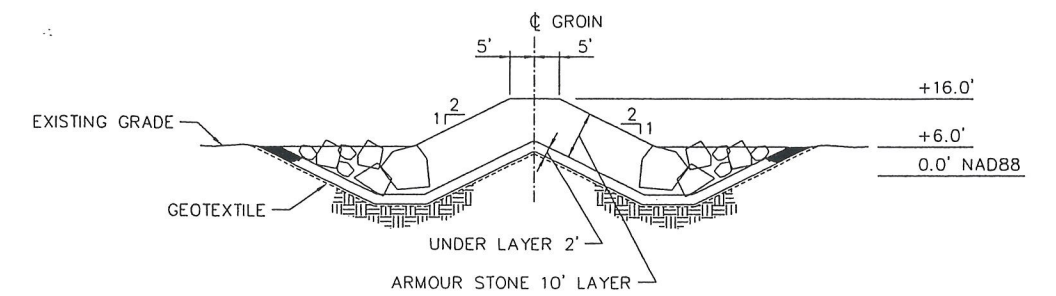

SECTION B-B  
ROCK DIKE SEAWARD END, TYPICAL

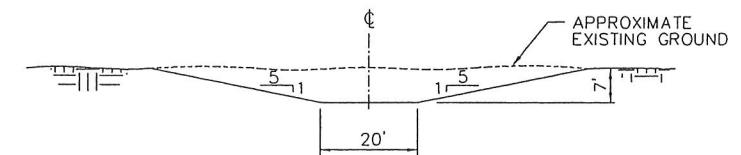

SECTION C-C  
EXCAVATED CHANNEL, TYPICAL

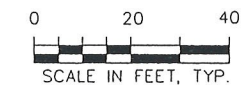



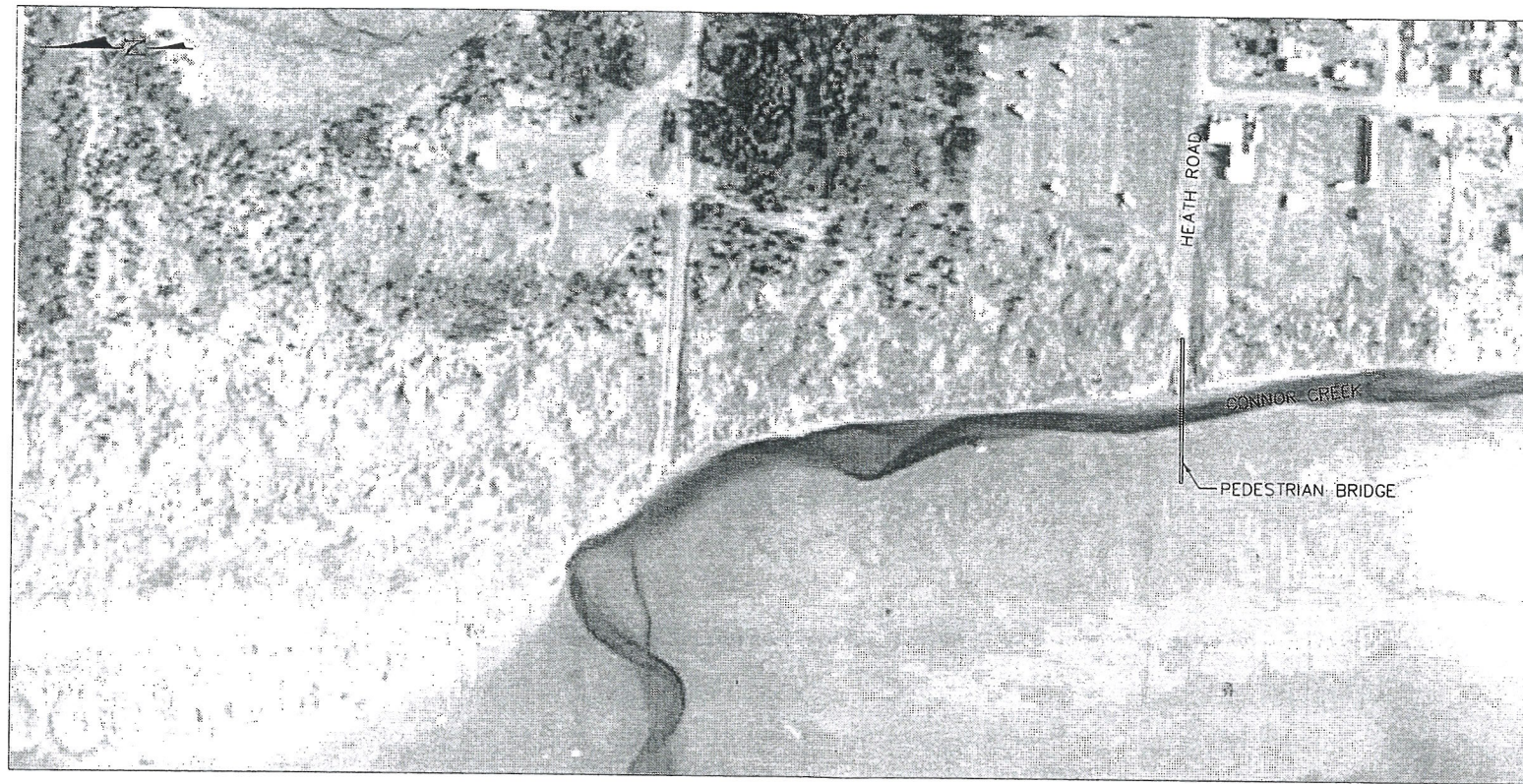

NOTES:  
 1. SURVEY VERTICAL CONTROL NAVD88  
 MHW = +8.4 FEET  
 MLLW = -0.98 FEET

DETAIL 1  
 1" = 400'

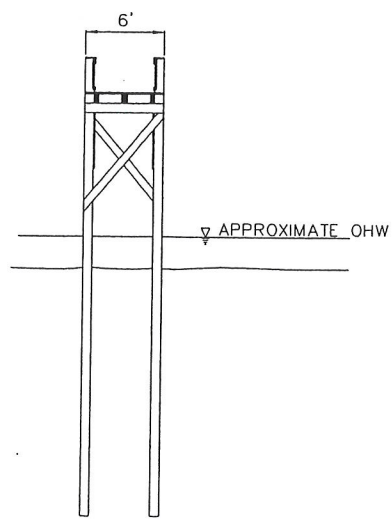

TYPICAL SECTION  
 0 15  
 SCALE IN FEET

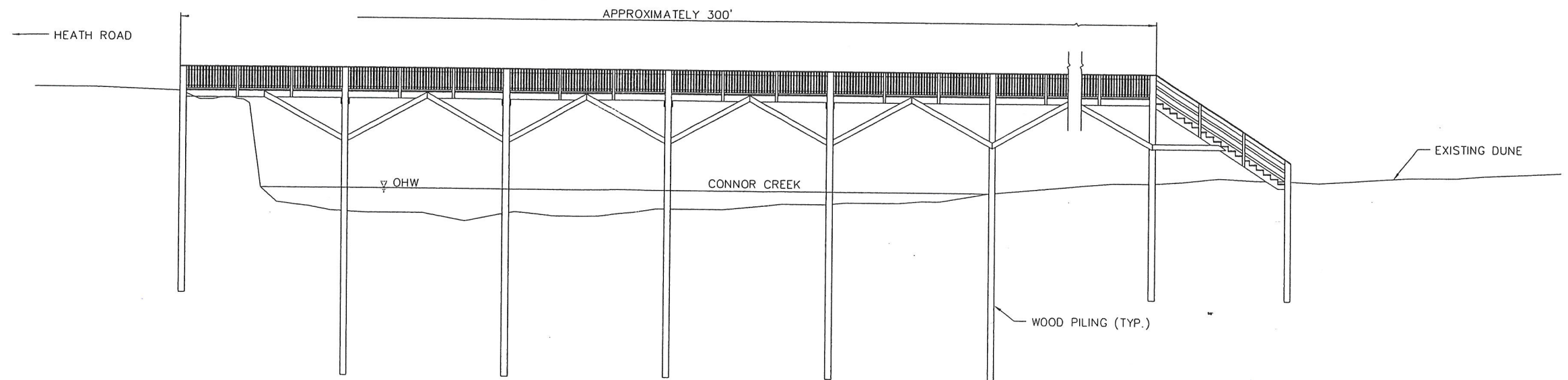

TYPICAL ELEVATION  
 0 15  
 SCALE IN FEET

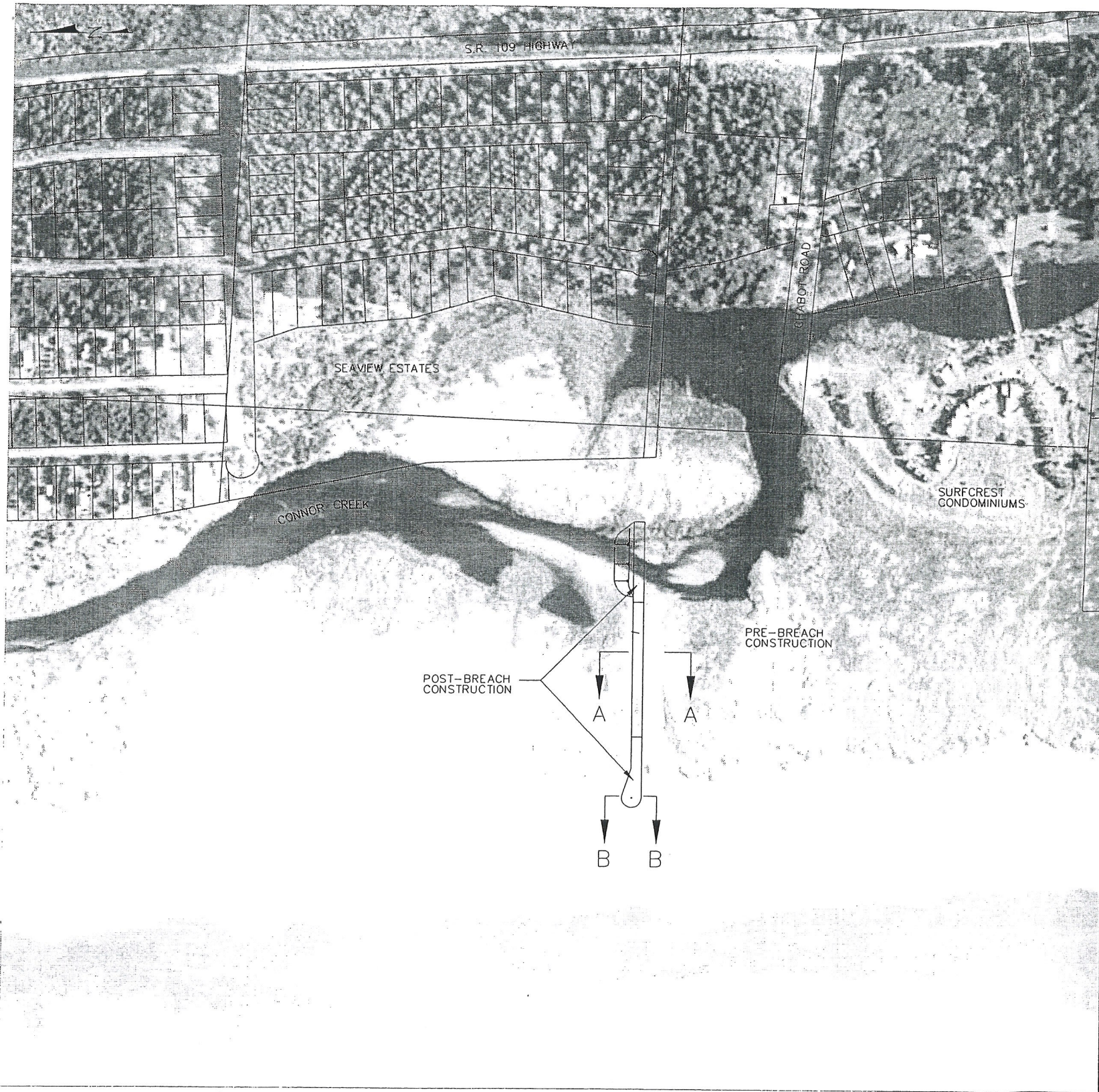

DETAIL 2  
1" = 400'

**NOTES:**

1. SURVEY VERTICAL CONTROL NAVD88  
MHHW = +8.4 FEET  
MLLW = -0.98 FEET
2. PROPERTY LINES SHOWN ARE APPROXIMATE LOCATION.

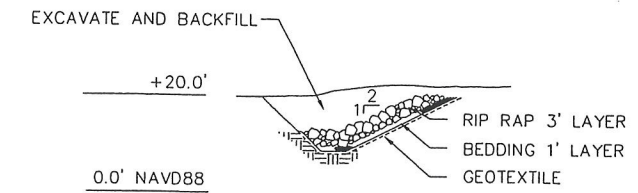

SECTION A-A  
SINGLE BURIED ROCK BARRIER, TYPICAL

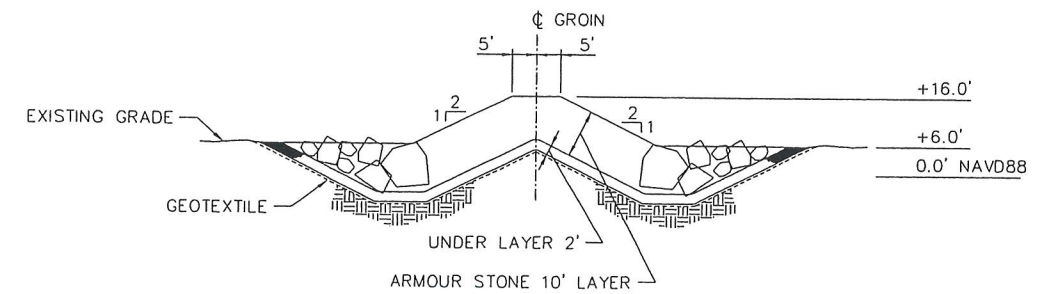

SECTION B-B  
POST-BREACH EXTENSION TO ROCK BARRIER, TYPICAL

